

HS-DX200 Level Transmitter

Features

- Integrated construction, unnecessary to do outer adjustment
- sensor housing protection IP68, connection box protection IP65;
- Cost-efficient, high reliability and stability;
- RoHS approved
- Explosion-proof product conforms to Exia II CT6 of Standard



Introduction

HS-DX200 is full sealed submersible level transmitter. It is made by building in high stable and reliable OEM piezo-resistive pressure sensor and high accurate circuit board into the stainless steel housing. Integrated construction and standard signal provide the user easy and convenient application in the local working place. The special cable connects with housing, can be immersed into the media for a long time.

HS-DX200 level transmitter has compact size, light weight and good stability; it can be used for water or liquid measure and control of medicine, metallurgy, electricity, mine, city water supply and drainage and hydrology, etc.

Specification

- Range (FS) : 1 2 5 10 20 50 100 200mH₂O
- Overpressure: 2 times FS
- Accuracy: 0.5%FS
- Stability: range > 20mH₂O, ±0.2%FS/年
range ≤ 20mH₂O, 20mmH₂O
- Thermal drift:

	zero	span
range > 10mH ₂ O	0.02%FS/°C	0.05%FS/°C
range ≤ 10mH ₂ O	0.05%FS/°C	0.05%FS/°C
- Application temp. range: -10~80°C;
- Storage temp. range: -40~100°C
- Power supply: 11~28VDC
- Output signal: 4~20mADC(2-wire)
- Load (Ω): <(U-11)/0.02

Construction Material

- Housing: stainless steel 1Cr18Ni9Ti
- O-ring: Viton
- Rubber casing: NBR

Cable: $\phi 7.5\text{mm}$ polyethylene cable

Diaphragm: stainless steel 316L

Outline Dimension

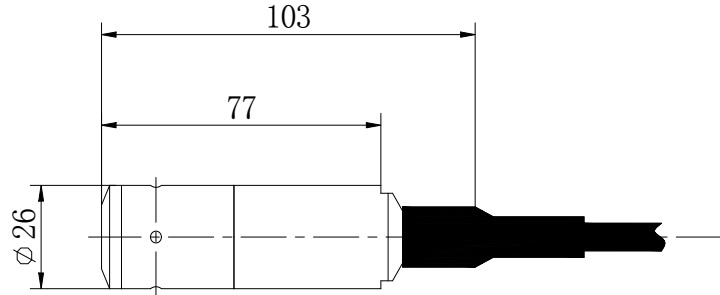

Electric Connection

Wire color	Connection
Black	+V
Red	0V/+OUT

Order Guide

HS-DX200	Level Transmitter		
	Range	Pressure range: 0~1...200mH ₂ O	
	[0~XmH ₂ O] L	X: actual measurement range L: cable length suggested L-X= (1~2) m	
	Code	Output signal	
	E	4~20mADC	
	Code	Construction material	
		Diaphragm Port Housing	
	22	SS 316L SS SS	
	24	SS 316L SS 316L SS 316L	
	25	Tantalum SS SS	
	Code	Others	
	M ₁	0~100% indicator	
	Y _b	Aluminum connection box without display	
	Y _c	MS200 water-proof connection box (default)	
	Y _d	PD140 lightning-proof protection device	
	Y _e	connection box(with display or without display)	
	i	Intrinsic safe version Exia II CT6	
	C ₁	M20×1.5 male	
	C ₃	G1/2 male	
	F ₁	Fixed flange	
HS-DX200	[0~2mH ₂ O]5	E 22 Yc	the whole spec